

## High Purity BioPharm Fittings

## Weld x Weld Eccentric Reducers - T32W

Size	Dimension A	PL finish - SF1 Part #	PM finish - SF4 Part #
3/4" x 1/2"	4.00"	<b>2211EBB075050F1</b>	<b>2211EBB075050F4</b>
1" x 1/2"	4.50"	<b>2211EBB100050F1</b>	<b>2211EBB100050F4</b>
1" x 3/4"	4.00"	<b>2211EBB100075F1</b>	<b>2211EBB100075F4</b>
1 1/2" x 3/4"	5.00"	<b>2211EBB150075F1</b>	<b>2211EBB150075F4</b>
1 1/2" x 1"	5.00"	<b>2211EBB150100F1</b>	<b>2211EBB150100F4</b>
2" x 1"	7.25"	<b>2211EBB200100F1</b>	<b>2211EBB200100F4</b>
2" x 1 1/2"	5.25"	<b>2211EBB200150F1</b>	<b>2211EBB200150F4</b>

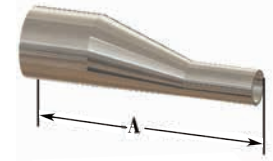

BPE Table DT-4.1.3-1(a)

Sanitary  
Fittings

## Clamp x Clamp Eccentric Reducers - T3214MP

Size	Dimension A	PL finish - SF1 Part #	PM finish - SF4 Part #
3/4" x 1/2"	2.000"	<b>2221EBB075050F1</b>	<b>2221EBB075050F4</b>
1" x 1/2"	2.500"	<b>2221EBB100050F1</b>	<b>2221EBB100050F4</b>
1" x 3/4"	2.000"	<b>2221EBB100075F1</b>	<b>2221EBB100075F4</b>
1 1/2" x 3/4"	3.000"	<b>2221EBB150075F1</b>	<b>2221EBB150075F4</b>
1 1/2" x 1"	3.000"	<b>2221EBB150100F1</b>	<b>2221EBB150100F4</b>
2" x 1"	5.000"	<b>2221EBB200100F1</b>	<b>2221EBB200100F4</b>
2" x 1 1/2"	3.000"	<b>2221EBB200150F1</b>	<b>2221EBB200150F4</b>

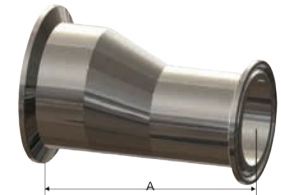

BPE Table DT-4.1.3-3(a)

PL Finish – SF1  
 OD = 32R<sub>a</sub> Mechanically Polished  
 ID = 20R<sub>a</sub> Mechanically Polished

PM Finish – SF4  
 OD = 32R<sub>a</sub> Mechanically Polished  
 ID = 15R<sub>a</sub> Mechanically Polished and Electropolished